

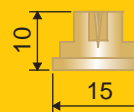

Utilizzo
Use
Utilización



Dimensioni (mm)
Size (mm)
Dimensiones (mm)





- Completamente costruito in ottone.
- Portata equivalente agli ugelli ISO.

- Fully made of brass.
- Same flow rate as ISO nozzles.

- Completamente fabricado el latón.
- Caudal equivalente a las boquillas ISO.



COD.	h	 bar	 l/min	L cm	5 km/h	6 km/h	7 km/h	8 km/h
OC102	45	2	0.65	140	56	47	40	35
		3	0.80	145	66	55	47	41
		4	0.92	150	74	62	53	46
	60	2	0.65	155	51	42	36	32
		3	0.80	160	60	50	43	38
		4	0.92	165	67	56	48	42
OC103	45	2	0.98	145	81	68	58	51
		3	1.20	150	96	80	69	60
		4	1.39	155	107	89	77	67
	60	2	0.98	165	71	59	51	45
		3	1.20	170	85	71	61	53
		4	1.39	176	94	79	67	59
OC104	45	2	1.31	170	92	77	66	58
		3	1.60	175	110	91	78	69
		4	1.85	180	123	103	88	77
	60	2	1.31	183	86	71	61	54
		3	1.60	190	101	84	72	63
		4	1.85	198	112	93	80	70
OC105	45	2	1.63	180	109	91	78	68
		3	2.00	183	131	109	94	82
		4	2.31	190	146	122	104	91
	60	2	1.63	195	100	84	72	63
		3	2.00	203	118	99	84	74
		4	2.31	223	124	104	89	78
OC106	45	2	1.96	190	124	103	88	77
		3	2.40	195	148	123	105	92
		4	2.77	203	164	137	117	102
	60	2	1.96	209	178	174	152	152
		3	2.40	230	125	104	89	78
		4	2.77	238	140	116	100	87
		5	3.10	245	152	204	130	179

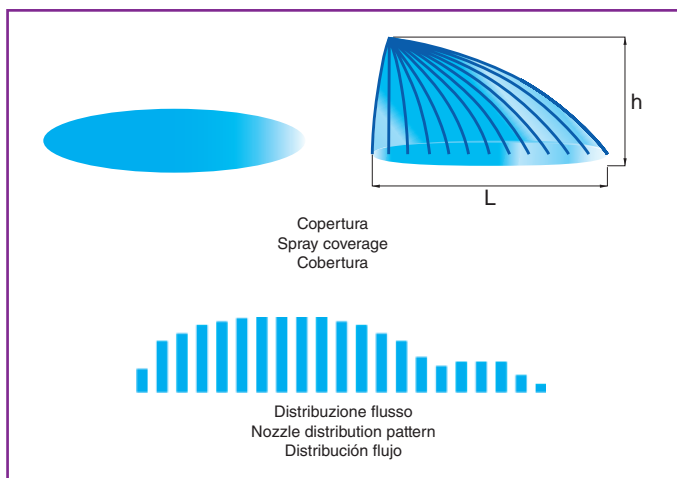

Off Center può essere utilizzato per due applicazioni differenti:
 - Posto a fine barra con il getto rivolto verso l'esterno, **(A)** consente il trattamento di aree in cui gli ugelli tradizionali non arrivano a causa dell'ingombro della barra.
 - Posto a fine barra ma con il getto rivolto verso l'interno, **(B)** evita la contaminazione di aree da non trattare.

Off Center can be used for two different applications:
 - At boom end, with jet pointing out, **(A)** to spray areas that traditional nozzles do not reach due to boom dimensions.
 - At boom end, with jet pointing in, **(B)** to avoid off-target spray contamination.

Off Center puede ser utilizado para dos aplicaciones diferentes:
 - Colocado al final de la barra con el chorro dirigido hacia el exterior, **(A)** permite el tratamiento de áreas donde las boquillas tradicionales no llegan debido a la barra.
 - Colocado al final de la barra pero con el chorro dirigido hacia el interior, **(B)** evita la contaminación de áreas que no se deben tratar.

